

SAL M27

LED Slim Architectural Linear – 2.75" Thickness **DESIGN XP**

Indirect/Direct | Gapless Continuously Illumination | Suspended/Surface/Wall Mounting

Due to continuous product improvements, specification and/or equipment updates may change without notice.



(Images are shown for illustration purposes only)

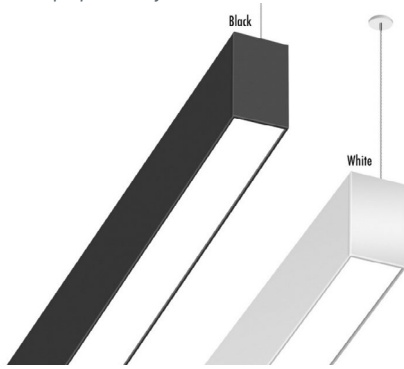

SAL M27

Features:

- 2' - 4' - 8' Linear Fixture lengths
- Black and White finishes
- Suspended/Surface/Wall mounting available
- PC Frosted lens standard (additional options available)
- Indirect/Direct switch with selectable distribution
- Integrated plug-in connectors for sleek designs

Dimensions:
 2.7" W x 3.15" H

Selectable CCT:
 3000K 3500K 4000K

Options:



Parabolic Lens

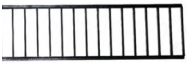

Louver Kits

Fixture linking:

Max. linkable quantity				
Down Linear	2'	4'	8'	
AC120V	18	9	5	
AC277V	43	21	12	

Up / Down Linear	2'	4'	8'	
AC120V	12	7	3	
AC277V	28	17	8	

Linear can be gapless as long as needed using multiple power cables.

Fixture Information:

Series Number	Length	Switch Setting	Lumens	Wattage
SAL M27 2	2'	High	2,880 Lm	25 W
		Medium	2,300 Lm	20 W
		Low	1,760 Lm	15 W
SAL M27 4	4'	High	5,760 Lm	50 W
		Medium	4,600 Lm	40 W
		Low	3,520 Lm	30 W
SAL M27 8	8'	High	11,520 Lm	100 W
		Medium	9,200 Lm	80 W
		Low	7,040 Lm	60 W

Connector Options:

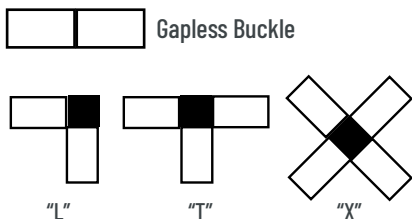

Selectable Distribution:

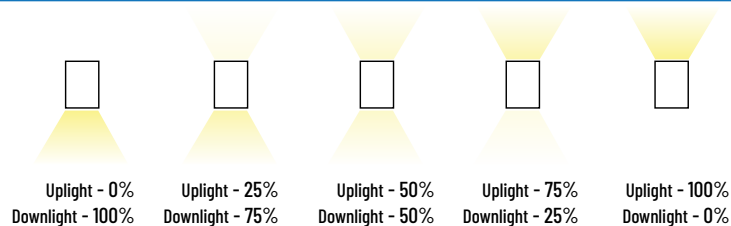

Distribution:

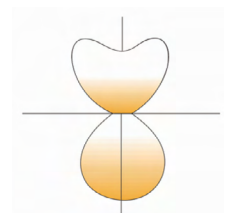

FIXTURE ORDERING GUIDE

Example: SAL M27 4 LS55 ID F G1 FSK W

Fixture	Width	Length	Selectable Lumen Output	Selectable Distribution	Lens	Generation	Voltage	Selectable CCT	Finish	Emergency Backup
• SAL Slim Architectural Linear	• M27 Medium 2.75"	• 2 2'	• LS28 2,880 Lm - 25W 2,300 Lm - 20W 1,760 Lm - 15W	• ID Internal Driver Uplight / Downlight - 0%/100% - 25%/75% - 50%/50% - 75%/25% - 100%/0%	• F Flat PC lens	• G1 Gen 1	• BLANK 120-277V	• FSK 3000K 3500K 4000K	• W White • B Black	• BLANK No backup. • EMD-PA08D-UNV-060* Emergency backup driver.
		• 4 4'	• LS55 5,760 Lm - 50W 4,600 Lm - 40W 3,520 Lm - 30W							
		• 8 8'	• LS110 11,520 Lm - 100W 9,200 Lm - 80W 7,040 Lm - 60W							

*Not available for 2' fixture.

ACCESSORIES

OPTIONAL ACCESSORIES

Power Cable

Power Cable Set with Wire Nut a Cable Tie - Max input 300V

Connectors

Fixture connector/splice box for fast connection of fixtures

Down Metal Cover

For 100% Uplight applications

Optics

Easily swapped out from the standard PC lens

Optics

Includes all hardware

Controls

Control box

MUST ORDER A POWER CABLE

WHITE FINISH

• SAL-5C-KIT-W-7FT

18 Gauge, 5 Conductors, White, 7 ft.

• SAL-5C-KIT-W-12FT

18 Gauge, 5 Conductors, White, 12 ft.

• SAL-6C-KIT-W-12FT

18 Gauge, 6 Conductors, White, 12 ft.

BLACK FINISH

• SAL-5C-KIT-B-7FT

18 Gauge, 5 Conductors, Black, 7 ft.

• SAL-5C-KIT-B-12FT

18 Gauge, 5 Conductors, Black, 12 ft.

• SAL-6C-KIT-B-12FT

18 Gauge, 6 Conductors, Black, 12 ft.

• SAL-M27-C-LC

Straight run connector - buckle, metal finish

• SAL-M27-C-WL

"L" shaped connector/splice box for 2 fixtures - White finish

• SAL-M27-C-WT

"T" shaped connector/splice box for 3 fixtures - White finish

• SAL-M27-C-WX

"X" shaped connector/splice box for 4 fixtures - White finish

• SAL-M27-C-BL

"L" shaped connector/splice box for 2 fixtures - Black finish

• SAL-M27-C-BT

"T" shaped connector/splice box for 3 fixtures - Black finish

• SAL-M27-C-BX

"X" shaped connector/splice box for 4 fixtures - Black finish

• SAL-M27-DMC-W-2FT

Down metal cover - White - 2ft

• SAL-M27-DMC-W-4FT

Down metal cover - White - 4ft

• SAL-M27-DMC-B-2FT

Down metal cover - Black - 2ft

• SAL-M27-DMC-B-4FT

Down metal cover - Black - 4ft

• SAL-M27-PAW-1FT

Parabolic Lens - 1 ft - White Finish

• SAL-M27-ECPAW

Endcap for Parabolic lens - White

• SAL-M27-PAB-1FT

Parabolic Lens - 1 ft - Black Finish

• SAL-M27-ECPAB

Endcap for Parabolic lens - Black

• SAL-M27-LOW-2FT

Louver Kit - 2 ft - White Finish

• SAL-M27-LOW-4FT

Louver Kit - 4 ft - White Finish

• SAL-M27-LOW-8FT

Louver Kit - 8 ft - White Finish

• SAL-M27-LOB-2FT

Louver Kit - 2 ft - Black Finish

• SAL-M27-LOB-4FT

Louver Kit - 4 ft - Black Finish

• SAL-M27-LOB-8FT

Louver Kit - 8 ft - Black Finish

• SAL-M27-ECB-W

External Control Box - White

• SAL-M27-ECB-B

External Control Box - Black

MOUNTING - KITS INCLUDE BRACKETS AND ALL HARDWARE NEEDED

Suspended

• SAL-SC-KIT-7FT Suspension Cable Kit - 7ft

• SAL-SC-KIT-12FT Suspension Cable Kit - 12ft

• SAL-DW-KIT-W Dry Wall Kit - White

• SAL-DC-KIT-W Drop Ceiling Kit - White

• SAL-DW-KIT-B Dry Wall Kit - Black

• SAL-DC-KIT-B Drop Ceiling Kit - Black

Wall Mount

• SAL-M27-WM-KIT-W-2FT

Wall Mount Kit - White - 2ft

• SAL-M27-WM-KIT-W-4FT

Wall Mount Kit - White - 4ft

• SAL-M27-WM-KIT-W-8FT

Wall Mount Kit - White - 8ft

• SAL-M27-WM-KIT-B-2FT

Wall Mount Kit - Black - 2ft

• SAL-M27-WM-KIT-B-4FT

Wall Mount Kit - Black - 4ft

• SAL-M27-WM-KIT-B-8FT

Wall Mount Kit - Black - 8ft

Surface Mount

• SAL-M27-SM-KIT-W-2FT

Surface Mount Kit - White - 2ft

• SAL-M27-SM-KIT-W-4FT

Surface Mount Kit - White - 4ft

• SAL-M27-SM-KIT-W-8FT

Surface Mount Kit - White - 8ft

• SAL-M27-SM-KIT-B-2FT

Surface Mount Kit - Black - 2ft

• SAL-M27-SM-KIT-B-4FT

Surface Mount Kit - Black - 4ft

• SAL-M27-SM-KIT-B-8FT

Surface Mount Kit - Black - 8ft

Suspension Cable Kit is mandatory for Dry Wall or Drop Ceiling Kits

Performance Information

Series Number	Power Percentage	Lumens	Wattage	CCT
SAL M27 2 LS28	High	2,880 Lm	25 W	3000K/ 3500K/ 4000K
	Med	2,300 Lm	20 W	
	Low	1,760 Lm	15 W	
SAL M27 4 LS55	High	5,760 Lm	50 W	
	Med	4,600 Lm	40 W	
	Low	3,520 Lm	30 W	
SAL M27 8 LS110	High	11,520 Lm	100 W	
	Med	9,200 Lm	80 W	
	Low	7,040 Lm	60 W	

Lumen Distribution:

Low: 880 Lm per foot
 Med: 1,150 Lm per foot
 High: 1,440 Lm per foot

Specifications

Housing

One-piece extruded aluminum with PC end caps.

Mounting

Suspended, wall mount, & surface mount.

Efficacy

Up to 115 lumens per watt.

CCT and CRI

Field selectable: 3000K, 3500K, and 4000K.
 CRI 80.

Lumen Output

Field selectable: 1,760 - 11,520 Lm.

Warranty

5-year limited warranty. Comprehensive warranty terms can be located on www.slgus.com.

Electrical

Standard 120V - 277V
 0-10V dimming standard with a dimming range of 100% to 10%.

Certifications

ETL Listed. Suitable for damp locations, indoor use only. FCC compliant. Design Lights Consortium® (DLC) 5.1 qualified product.

Emergency Backup Specifications

Product Specification			
Input Voltage	100-347V AC, 50/60Hz	Output Voltage	30-60V DC
Input Current (Max)	100mA	Charging Current (Max)	250mA
Input Power (Max)	8 W	Output Power	8 W
Emergency Time	90 Minutes	Battery Type	Lithium ion battery
Charging Time	≥ 24 Hours	Ambient Temp	5°C - 50°C (41°F - 122°F)



EMD-PA08D-UNV-060*

*Not available for 2' fixture.

SAL 2.7"



Dimensions

SAL M27 2



SAL M27 4



SAL M27 8



Mounting



Drop Ceiling Suspension Kit

- 2 pcs 5" Slim Canopy with metal bracket
- 1 pc 1.7" Slim Canopy
- 1 pc Junction Box
- 2 pcs Grommet
- 2 pcs Washer
- 4 pcs Screws M4x8mm
- 2 pcs Assembled T-Grid Clips

Drywall Suspension Kit

- 2 pcs 5" Slim Canopy with metal bracket
- 1 pc 1.7" Slim Canopy
- 2 pcs Butterfly Drywall Anchor
- 2 pcs Grommet
- 2 pcs Washer
- 4 pcs Screws M4x8mm
- Manual
- PE bag

STB Suspension Kit

- 2 pcs 5" Aircraft Cable 6ft
- 2 pcs Butterfly Drywall Anchor
- 4 pcs Screws PA4x30mm
- Manual

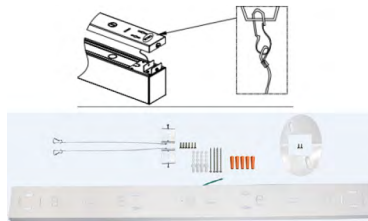

Wall Mount

(Includes wall bracket and hardware).

Surface Mount

(Includes surface bracket and hardware).

Connectors



T-Joiner

T-Shape metal splice, available in white & black.



L-Joiner

L-Shape metal splice, available in white & black.



X-Joiner

X-Shape metal splice, available in white & black.

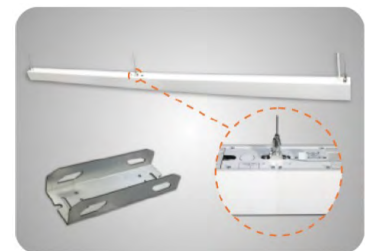

Buckle-Joiner

Straight metal splice buckle, available in white & black.

Optics



Parabolic Lens

1ft parabolic lense, available in white & black.

PC Louver Kit

Louder Kit, includes all hardware, available in white and black finishes and 2ft, 4ft, and 8ft lengths.

Power Cable



Power Cable Kit

18 gauge, 5 conductors, available in white and black and 7ft / 12ft lengths.

Down Metal Cover



Down Metal Cover

Metal cover, available in white and black finishes as well as 2ft and 4ft lengths.

Control Box

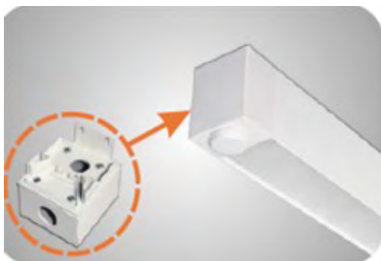

Control Box

External control box. Available in white and black finishes.

Electrical Load

	Power Setting	Wattage	Current (A)			
			120V	208V	240V	277V
SAL M27 2 LS28	Low	15 W	0.13	0.07	0.06	0.05
	Med	20 W	0.17	0.1	0.08	0.07
	High	25 W	0.21	0.12	0.10	0.09
SAL M27 4 LS55	Low	30 W	0.25	0.14	0.13	0.11
	Med	40 W	0.33	0.19	0.17	0.14
	High	50 W	0.42	0.24	0.21	0.18
SAL M27 8 LS110	Low	60 W	0.5	0.29	0.25	0.22
	Med	80 W	0.67	0.38	0.33	0.29
	High	100 W	0.83	0.48	0.42	0.36

Shipping Information

Product Number	Individual Box Size	Individual Box Weight	Outer Carton Size	Outer Carton Weight	# Per Carton	# Per Pallet
SAL M27 2 LS28 G1 FSK	4.1" x 4.7" x 26"	3.17 lbs (Net Weight) 3.59 lbs (Gross Weight)	9.25" x 10.2" x 26.8"	14.99 lbs (Net Weight) 17.53 (Gross Weight)	4	-
SAL M27 4 LS55 G1 FSK	4.7" x 4.1" x 29.2"	6.13 lbs (Net Weight) 6.83 lbs (Gross Weight)	9.25" x 10.2" x 50.4"	24.52 lbs (Net Weight) 29.59 lbs (Gross Weight)	4	-
SAL M27 8 LS110 G1 FSK	4.5" x 4.7" x 96.5"	12.04 lbs (Net Weight) 13.47 lbs (Gross Weight)	10.2" x 5.3" x 97.6"	24.07 lbs (Net Weight) 29.15 lbs (Gross Weight)	2	-